

# EC-II

PROUDLY BUILT BY  
ELKHART COACH



A DIVISION OF FOREST RIVER



# CHEVY EC-II STANDARDS AND OPTIONS

## STANDARD CHASSIS FEATURES

- Chevrolet Express G-3500 & G-4500 Cut-Away Chassis
- Electronic 6-Speed Automatic Transmission
- 33 or 57 Gallon Fuel Tank
- Chevy V-8 Duramax 6.6L Turbo Diesel
- Chevy V-8 Vortec 6.0L SFI (Gas)
- OEM Installed Dash Air Conditioning & Heat
- Dual 145 Amp Alternators (Single on Gas)
- 139", 159", 177", 190" Wheelbases
- Heavy Duty Engine Cooling Package
- Chrome Front Bumper
- 12,300 & 14,200 GVWR
- Dual Electric Horns
- Driver Air Bag
- Heavy Duty Suspension
- Power Steering/Brakes
- LT225 / 75R16E Tires
- Dual 770 (Diesel) & 600 (Gas) CCA Batteries
- Tilt Steering Wheel/Cruise Control
- Dual Beam Headlights
- Daytime Running Lights
- High Idle

## STANDARD BODY FEATURES

- FMVSS/CMVSS Certified
- STURAA Tested for 7 Years/200,000 Miles
- Fully Welded Unitized Steel Cage Body Structure
- Insulated Roof & Exterior Walls

- All Aluminum Sidewalls and Skirts
- Laminated Steel Reinforced Composite Construction
- Single Piece Seamless FRP Roof
- Smooth FRP Interior Walls
- FRP Ceiling
- Undercoating
- Dual Drive Shaft Guards
- Mor-View Right Side Cab Window
- Smooth Rubber Floor w/ Ribbed-Rubber Aisles
- Rear ABS Fender Flares
- Rear Mud Flaps
- Powder Coated Rear Steel Bumper
- Entrance Door & Driver Modesty Panels
- White or Yellow Step Nosing — All Entry Steps
- Entry Door Assist Handles
- Swing-A-Way Exterior Flat Mirrors with Integrated Convex Panels
- Drip Rail Over Passenger Windows & Entry Doors
- Color/Function Coded Wiring Harness
- Master Electronic Printed Circuit Control Panel
- Emergency Side Egress Windows
- Stylized ABS Rear Trim
- 91" Interior Width & 77" Headroom
- Large 36" x 36" & 24" x 36" Upper T-Slider Windows
- 22" x 64" Rear Egress Window

## POPULAR OPTIONS

- Rear Heat System
- Rear A/C System
- Mor/Ryde Suspension
- "Flat Floor" (No Wheel Well Risers)
- Spare Tire & Wheel
- Stainless Steel Wheel Inserts
- Driver Running Board
- Front Mud Flaps
- Interior Luggage Rack
- Individual Reading Lights
- Interior Convex Mirror
- Back-Up Alarm
- Overhead Luggage Racks
- Rear Luggage Compartment
- Ceiling Grab Rails
- AM/FM Radio w/ CD Player
- DVD Player w/ Flip Down Monitor
- Ground Plane For Two-Way Radio Installation
- ADA Mobility Compliance Package
- Paging System
- Front and Side Destination Signs
- Roof Escape Hatch
- Heated/Remote Exterior Mirrors
- High-Back or Mid-High Seats with Armrests
- LED Interior & Exterior Lighting
- Exterior Rear Center Mount Brake Light
- Rear Emergency Door with Ajar Package
- Electric Entry Door
- All FRP Exterior

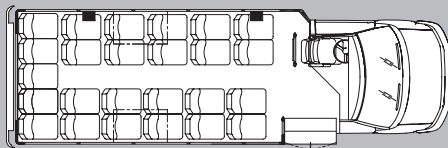

25 Passenger — Forward Facing Seating

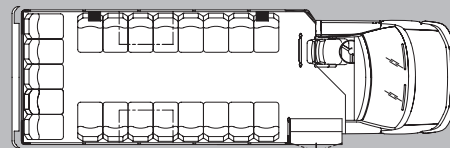

21 Passenger — Perimeter Seating

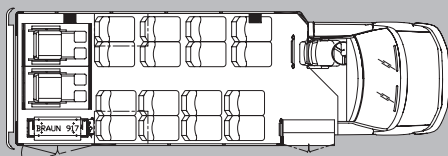

16 Passenger — Two Wheelchairs — Rear Lift

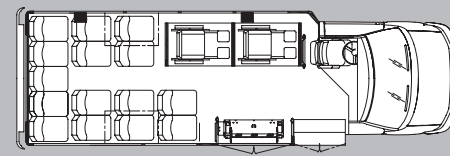

15 Passenger — Two Wheelchairs — Front Lift



Forest River, Inc. 55470 C.R. 1 Elkhart, IN 46515-3030  
574.389.4600 [www.forestriverinc.com](http://www.forestriverinc.com) [www.forestriveraccessories.com](http://www.forestriveraccessories.com)

## YOUR DEALER



(800) 330-1175

[www.matthewsbusescommercial.com](http://www.matthewsbusescommercial.com)